

G0 Core

User Manual

Serial #G0C 01 00001



NORDISK
CLEAN SOLUTIONS

Jägershillgatan 13
SE-213 75 MALMÖ, Sweden

Art. no EN31177

Nordisk Clean Solutions retains the right to make technical changes to the products.

No responsibility is taken for any printing errors.

www.nordiskclean.com

Tel. +46 40 671 50 60

Contents

EC DECLARATION OF CONFORMITY FOR MACHINERY	5
1 General descriptions and safety	7
1.1 To the user	7
1.2 Notes and warnings	8
1.3 Technical data G0 Core	10
1.4 SIMpel	12
2 Operating	15
2.1 Control panel	15
2.2 Start and operation	16
2.3 Load the wash ware	18
3 Daily clean	19
3.1 Clean the filter	19
3.2 Clean the wash and rinse arms	20
4 Error icons and troubleshooting	23
4.1 Error icons in the display	23
4.2 Troubleshooting	24
4.3 Notes	26

EC DECLARATION OF CONFORMITY FOR MACHINERY

Original

Directive 2006/42/EC, Annex II 1A

Manufacturer (and where appropriate the authorized representative):

Representative: Nordisk Clean Solutions
Address: Jägershillsgatan 13, 213 75 Malmö

Hereby declares that

Type of machinery: Commercial glass washer
Number of machinery: G0 Core G0C-01 00001

Complies with the requirements of Machinery Directive 2006/42/EC.

Complies with the applicable requirements of the following EC directives:

2014/35/EU, LVD

2014/30/EU, EMC

The following harmonized standards have been applied:

EN 60335-2-58:2017

EN 60335-2-58:2005/A12:2016

EN 55014-1:2017/A11:2020

EN 55014-2:2015

EN 61000-3-2:2019

EN 61000-3-3:2013/A1:2019

EN 61000-6-2:2019

EN 61000-6-3:2007/A1:2011/AC:2012

The following other standards and specifications have been applied:

SS-EN 1717:2000

Authorized to compile the technical file:

Name: Staffan Stegmark
Address: Jägershillsgatan 13, 213 75 Malmö
Place and date: Malmö, 01.03.2024
Signature:



Name: Mikael Samuelsson
Position: CEO

1 General descriptions and safety

1.1 To the user

Thank you for choosing a Nor:disk Clean Solutions product.

Read the instructions in this manual thoroughly. Follow all provided guidance to ensure that you operate the appliance in a safe and efficient way.

At all times – Obey the safety instructions – The safety instructions are written for your safety, the safety of nearby persons, and to prevent accidental misuse of the machinery.

The machine is CE marked, which means that it meets the requirements of the EU Machine Directive regarding product safety. Product safety is ensured within the machine's design that is engineered to prevent personal injury or property damage. Modifications made to the equipment without the manufacturer's approval will void the manufacturer's product liability.

Nor:disk Clean Solutions accepts no responsibility for damage to the equipment or other damage or injury caused by not following instructions or safety precautions written in this manual.

Keep this manual available throughout the machine's life span. If you seek further information about this machine or information related to operators training you will find this and more on: [Nor:disk Clean Solutions](#).

Find user tutorials, accessory tutorials, customer case videos, and webinars on our [You tube channel](#).

There is a sticker with a QR code placed on the machine's front. Scan this and get direct access to machine specific information and knowledge (see chapter about SIMpel in this manual).

User manual in original

1.2 Notes and warnings

This product is a professional solution for washing glasses in rooms with an ambient temperature between a minimum of 5° C and a maximum of 35° C. It must be used by adults and authorized personnel only. It must be installed and repaired exclusively by a qualified technician. The manufacturer declines all forms of responsibility deriving from improper use, maintenance and repairs.

The product is not intended for use by minors or by persons with restricted physical, sensory or mental abilities, who do not possess the requisite expertise and understanding for its safe operation. These persons may use the machine exclusively under the supervision of a person responsible for their safety.



NOTE

The following fundamental rules must be observed when using this appliance:

- Never use the appliance with bare feet.
- Do not put your bare hands into water containing detergent. If so immediately wash your hands with running water.
- Do not clean the machine's exterior/outside with large amounts of water. Use only a damp cloth.
- The machine is designed only and exclusively to wash glasses, dish ware and cookware soiled with residues of human food.
- Do not insert solvents such as alcohol or turpentine into the machine, which could cause an explosion. Do not insert dishes with ash, wax or varnish residues into the machine.
- Do not use the appliance to wash objects soiled with petrol or paint. Do not wash pieces of steel or metal, fragile objects or objects made of material that will not withstand the washing process. Do not use acid or alkaline corrosive chemical products, solvents or chlorine based detergent.
- Never use the dishwasher or its parts as a stepladder or support for persons, things or animals. Leaning or sitting upon the dishwasher's open door or hood could cause an overturn with consequent danger to people in the proximity.

The user must not carry out any repairs or maintenance works on the dishwasher. The machine is CE marked. The CE mark is only valid for machines in their original design. Service and maintenance must be carried

out by qualified and authorized personnel. Any assistance required on this dishwasher must be carried out by authorized personnel.



WARNING

The machine uses hot water. Risk of scalding.

Do not open the door of the dishwasher during operation.

The dishwasher is equipped with a safety device that immediately stop the wash cycle to avoid the leakage of water if the doors should be opened accidentally. Always remember to switch the dishwasher off and to empty the tank before accessing it to clean it or for any other reason.



ELECTRICAL

Do not use water to extinguish fire on electrical parts.

Regarding the handling and use of detergent and rinse aid with the product, please see the chemical manufacturer's instructions. Use high quality products for best wash result. Use protective gloves and eye protection when handling the chemicals.

1.3 Technical data G0 Core

General

Design	Under counter glass washer
External dimensions H x W x D (Door open)	702 mm (+10 mm) x 465 mm x 525 mm (865 mm)
Clearance (Loading height)	305 mm (280 mm)
Weight (empty / filled)	31 kg/49 kg(Standard machine)
Tank volume	12 litres
Rinse tank volume	5,5 litres
Rinse water volume	2,4 litres
Wash water temperature***	60 °C
Rinse water temperature***	70 °C
Sound pressure level	48 dB(A) ISO 11203

PROGRAMS & CAPACITY

Washing programs	P1: 1 min. P2: 2 min. P3: 3 min. P4: 8 min.
Capacity per program	Depending on the size of the glasses- 16 Glasses Ø 85 mm - 25 Glasses Ø 65 mm
Start-up time (filling and heating)	17 min at 55 °C inlet water temperature

ELECTRICAL CONNECTION

Voltage**	230 V/ 1 N~/ 50 Hz
Fuse	16 A (230 V/ 1 N~)
Frequency	50 Hz
Maximum output	3,1 kW
Dish washing pump	0,27 kW
Rinse pump	0,18 kW
Heater wash tank*	1,6 kW
Heater rinse tank*	2,8 kW
Enclosure rating****	IPX1

WATER CONNECTION

Hardness/Connection	Total hardness: < 4 °dH; 7 °f; 70 PPM
	1,5 m. Inlet hose with ¾" female threading
	200 – 500 kPa (2 – 5 bar)

VENTILATION & DRAIN

Ventilation requirements	200 m³/h
Heat emitted to room (total/sensible/latent)	1,1 kW / 0,7 kW / 0,4 kW
Drainage	Drain hose Ø 28 mm – 1,4 m
Drain capacity requirement	50 l / min.
Drain water temperature	65 °C
Drain pump	40 W
Maximum lift height drain pump	400 mm

DETERGENT & RINSE AID

Liquid detergent and rinse aid dosing dispenser with a peristaltic pump are integrated into the machine. The hoses and the dipsticks are included in the delivery. Use the transparent hose for the rinse aid.

* Not in use simultaneously.

** For specific data regarding delivered units, please see the machine rating plate.

*** Factory settings. The settings can be changed according to local standards.

**** Do not clean the machine's exterior with water. Use a damp cloth.

1.4 SIMpel

SIMpel provides the user with manuals and further knowledge about the G0 Core.



- 1 Scan the QR code on the sticker that is placed on the machine.



Fig. 1 Sticker

- 2 When you scan the QR code, you enter the following user menu.

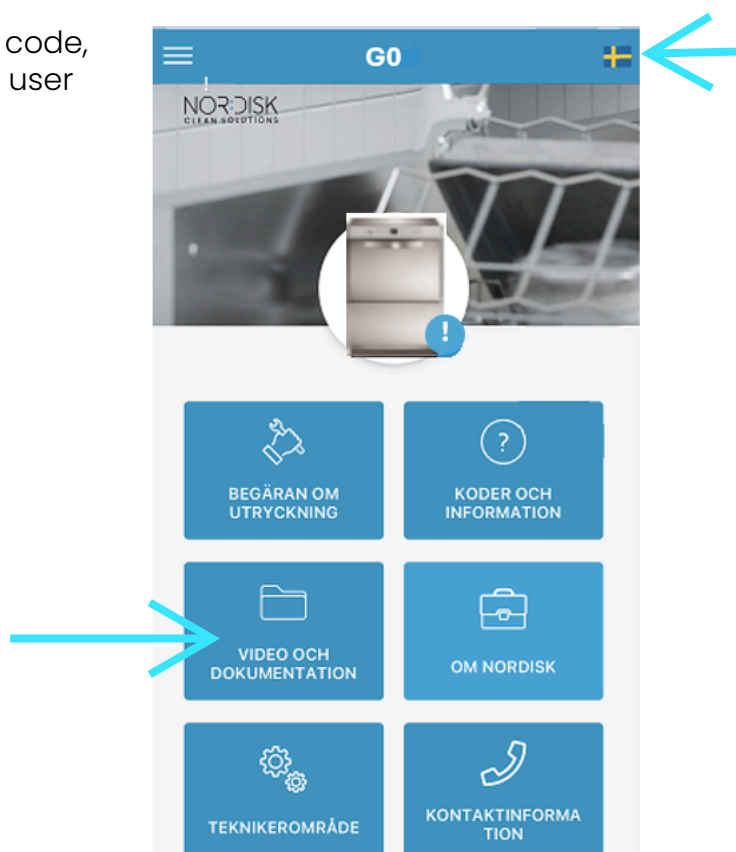

- 3 Select the language flag in the upper right corner. English is default.

Explanation of the different boxes:

1. SERVICE REQUEST	Not in use.
2. VIDEO AND DOCUMENTATION	Here you find useful videos and instruction manuals.
3. TECHNICIANS AREA	Here the technician fills in all maintenance operations that have been performed on the machine.
1. ERROR CODES.	List of error codes with information.
5. ABOUT NOR:DISK	Link to our website.
6. CONTACT INFORMATION	Not in use.

2 Operating

2.1 Control panel



NOTE

*Use the mains power supply to activate the stand by mode.
The display will show: OFF (stand by mode).*

1. ON (START)/OFF (STOP) button
2. P — choose wash program
3. CONFIRM — start the selected wash program

2.2 Start and operation

- 1 Switch on the main electrical switch. The display shows OFF (stand-by mode).
- 2 Press ON/OFF button. The display shows: HELLO and the machine immediately starts to fill both tanks with water. The water is then heated until the correct temperature is reached in each of the tanks.



Fig. 2 Filling with water

The CONFIRM button is yellow during the filling and heating phase.

See Fig. 2 *Filling with water*

- 3 The machine is ready to operate when the arrow on the CONFIRM button is green.



See Fig. 3 *Ready to use*

Fig. 3 Ready to use

- 4 Choose wash program by pressing P until the digit (program) appears in the display.
 - P1: 1 min..
 - P2: 2 min.
 - P3: 3 min.
 - P4: 8 min.
- 5 Press the CONFIRM button (green arrow-head) to start the wash program.
- 6 When the machine is running a countdown of the program length appears in the display. During this phase the CONFIRM button is blue.

The wash program is ready when END flashes in the display for a couple of seconds and the CONFIRM button turns green again.

**NOTE**

As long as correct temperature in the wash tank is not achieved, thermostop for wash tank will be activated.

The machine will not be able to start. The CONFIRM button and chosen program will be blinking waiting for correct temperature.

**NOTE**

If correct temperature is not achieved during the rinse cycle, thermostop for rinse tank will be activated.

The countdown of time will stop and the rinse temperature will start blinking.

When correct temperature is reached the program and countdown continues.

**NOTE**

When the unit is not used for 20 minutes (this time can be programmed from the technicians menu) it will enter Economy mode, keeping the temperatures lower to save energy. To exit the function, press any button on the display.

2.3 Load the wash ware

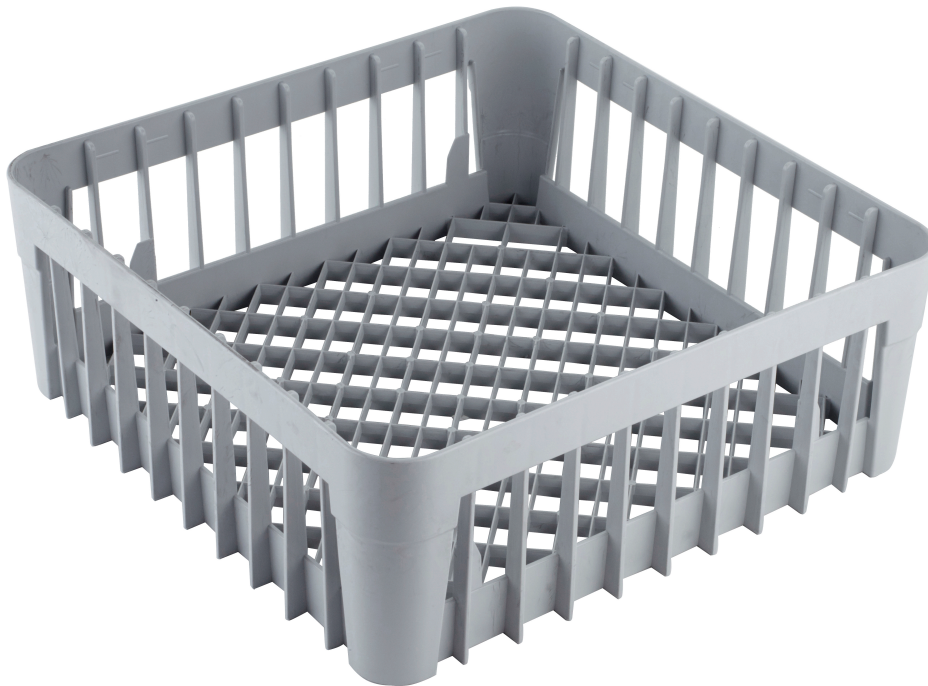

Glass ware basket (400 mm. x 400 mm.) for glasses and mugs (article number: 30659).

3 Daily clean

3.1 Clean the filter

Follow these instructional steps:

1. Push the black button to empty the water from the tank. The drain starts immediately after the black button is pushed.
2. When the wash tank is empty: Switch the power supply OFF!
3. Remove the filter (inside the filter is a second filter).
4. Clean the two filters and rinse them thoroughly with running water.
5. Put the clean filters back again (the small filter before the larger one).



3.2 Clean the wash and rinse arms



The wash arms and the rinse arms need to be cleaned at the end of the day. The arms are attached with a nut that is easy to remove with your hand.

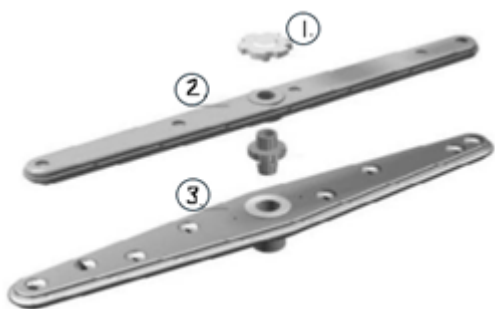

Follow these instructional steps:

1. Undo the nut(1) and remove the arms(2 and 3).
2. Clean the arms and rinse them thoroughly with running water.
3. Put the arms back to their place again.
4. Do not tighten the nuts too hard.

At the end of the day, leave the door open to let air circulate.

**NOTE**

If the appliance is not going to be used for quite some time you have to:

- 1. Empty the detergent and rinse aid dispensing device to avoid crystallizations and damages to the pump.*
- 2. Remove the priming pipes from the detergent and rinse aid containers and soak them in a container of clean water.*
- 3. Run some wash cycles and empty the machine completely.*
- 4. Finally, switch off the power supply (main off/on switch) and turn off the water (supply inlet tap).*

4 Error icons and troubleshooting

4.1 Error icons in the display

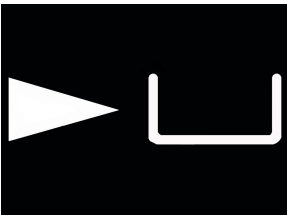
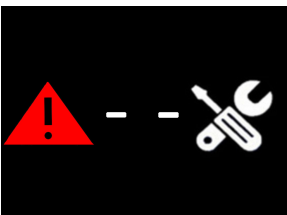
ERROR ICONS	MEANING	SOLUTION
	Failed filling wash/ rinse tank charging time exceeded.	Pressing start resets the time hence repeating the load. Check the mains water inlet. If the problem persists after switching off and on again, call for technical assistance.
	Anomaly or breakage of the temperature sensor in the wash tank or in the rinse tank.	Switch off and on again. If the problem persists, call for technical assistance.

4.2 Troubleshooting

PROBLEM	POSSIBLE CAUSE	POSSIBLE SOLUTION
The mains light fails to switch on.	Mains are not connected.	Check the electric mains connection.
The wash cycle fails to start.	The machine has not yet been filled. The machine has not reached the appropriate temperature yet.	Wait until the CONFIRM button has turned green.
Poor washing result.	The spray arms are clogged, or scale is obstructing them. Not enough or unsuitable detergent or rinse aid. Plates/glasses not positioned correctly. Too low wash temperature. The set cycle is unsuitable.	Dismantle and clean the spray arms. Check the type and concentration of detergent/ rinse aid. Arrange the plates/ glasses correctly. Check the temperature – if too low, call for technical assistance. Choose a longer program.
Insufficient rinsing.	The spray holes in rinse arms are clogged with food, or scale is obstructing them.	Dismantle and clean the rinse arms.

The glasses and cutlery are stained.	The rinse aid is unsuitable or is not dispensed correctly.	Check the rinse aid container and if it is suitable for the type of mains water. If the problem persists, contact chemical supplier.
Water in the tank after draining.	The drain filter is obstructed.	Clean the filter.

4.3 Notes