

D1 Base technical specifications



Top level hygiene

The Water-Smart range delivers top wash results that complies with the EN 17735:2023 and DIN 10534 hygiene norms.



Instant access to information

Scan the QR code for online access to servicing history, user and service manuals or troubleshooting guides.

That's SIMpel™!



General

Design	Undercounter dishwashing machine
External dimensions H x W x D	844 (+10) x 600 x 633/1072
Clearance (Loading height)	400 mm (375 mm)
Weight (empty/filled)	54 / 74 kg
Wash tank volume	11 litres
Rinse tank volume	5.5 litres
Rinse water volume	2.2 litres
Wash/rinse water temperature	60/85 °C
Sound pressure level	< 56 dB(A) ISO 11203

Programs & capacity

Wash programs	1:30 min / 2 min / 3min / 8 min
Capacity / wash program	18 Dinner plates or 12 Soup plates Ø 240 mm 25 Glasses/mugs Ø 90 mm
Start-up time	15 min. at 55 °C inlet water temperature

Electrical connection ①

Voltage	380/400/415V/ 3N~ / 50 Hz 230V/ 3N~ / 50 Hz 380/400/415V/ 3N~ / 60 Hz 230V/ 1N~ / 50 Hz (switchable)
Fuse	10 A (400V) / 16 A (230V) / 25 A (230V / 1N~ with 5.1 kW or 16 A (230V / 1N~ with 3.5 kW)
Maximum output	5.1 kW
Dishwashing pump	0.55 kW
Rinse pump	0.18 kW
Heater wash/rinse tank*	2 kW / 4.5 kW
Enclosure rating	IPX5

Water connection ②

Hardness/Connection	Total hardness: < 4 °dH; 7 °f; 70 PPM Inlet hose with ¾" female - 1.5 m 200 - 500 kPa (2 - 5 bar)
Max. inlet water temperature	60 °C

Ventilation & Drain ③

Heat dissipation	1.6 kW / 0.7 kW / 0.9 kW (total/sensible/latent)
Ventilation requirement	500 m³/h
Drainage	Drain hose Ø 28 mm , 1 m, capacity 50 l/min
Drain water temperature	65 °C
Integrated drain pump (option)	40 W, Lift capacity: 400 mm

Detergent & rinse aid

Dosing equipment	Liquid rinse aid dosing dispensers with peristaltic pump, integrated in the machine (detergent option)
------------------	--

* Not in use simultaneously.



On-site customizations

Wash/rinse temperatures and chemical dosing are all fully customizable on site.

D1 Base technical drawing

- ① Electrical
- ② Water supply
- ③ Drain

(mm)

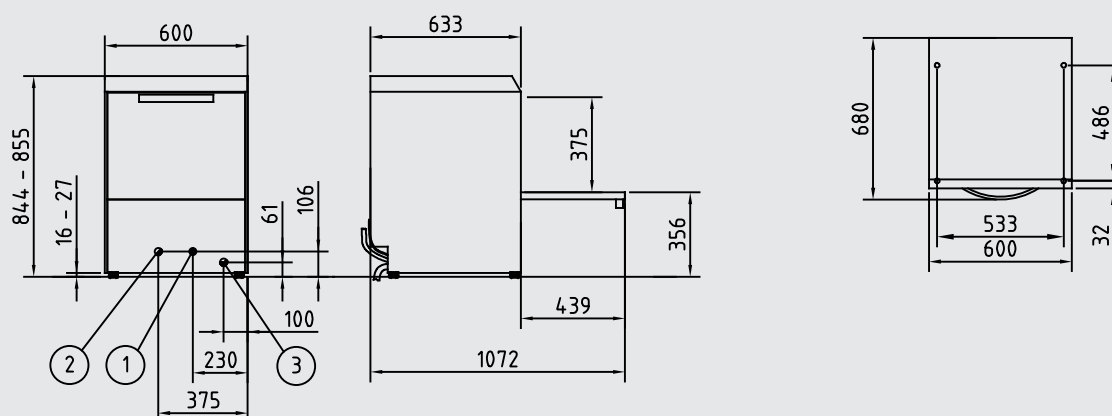

Stand (option)

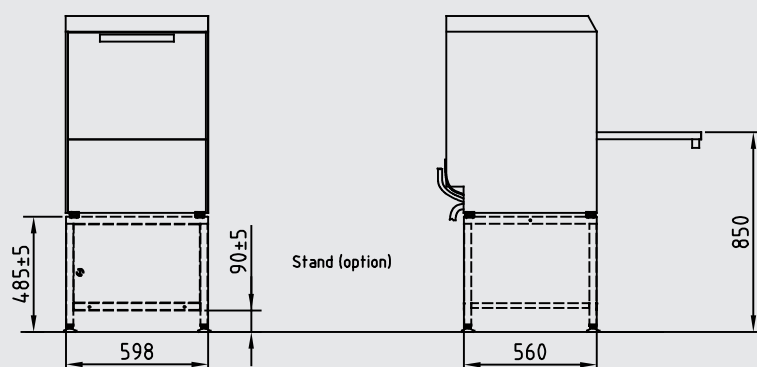

2-year
warranty

24

Enjoy a contractual
24-month warranty on
your new Nor:disk ware
washing solution.

*Annual service must be
performed by your local
authorized service partner.*

NOR:DISK
CLEAN SOLUTIONS

www.nordiskclean.com